

Opening the safe with emergency battery

If the batteries of the safe run out you can use a 9V battery to power up the lock.

- 1 connect the battery to the 9V battery port on the bottom left of the faceplate

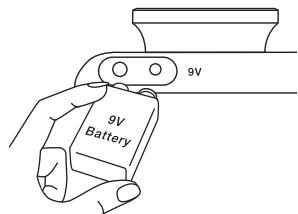

- 2 touch the panel

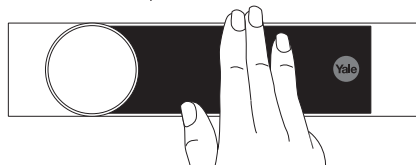

- 3 insert code → press 

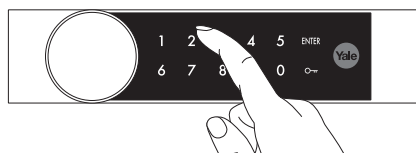

- 4 turn the knob and open the safe

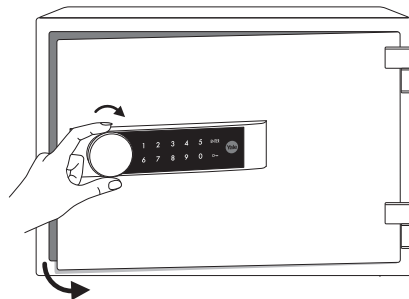

- 5 replace batteries as instructed under "Installing the batteries"

 Keep a 9V battery available to be able to open the safe in case the batteries run out unexpectedly.

 When batteries need changing these will be a warning sound when you open the safe.

Treasuring your freedom

Yale Fire Safe User Manual

For Models:

YFM/310/FG2

YFM/420/FG2

YFM/520/FG2

YDM/420/FG3

Please keep manual safe
for future reference.



Recycled materials

For any inquiries visit www.yalelock.com

An ASSA ABLOY Group brand **ASSA ABLOY**

The world's favorite lock

Yale[®]

Default user passcode registration

- 1 open the safe find the programming button

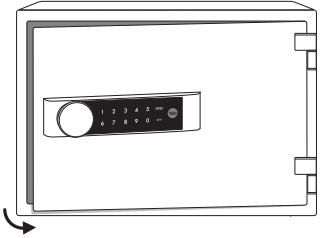

- 2 wake the safe up by pressig the programming button

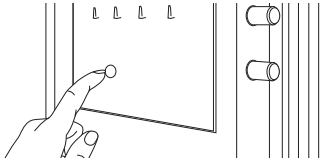

- 3 insert code

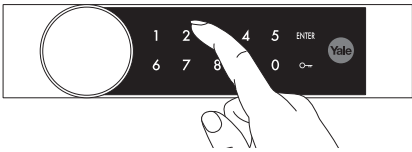

- 4 press the programming button

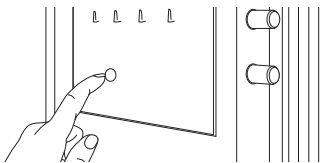

Additional user passcode registration

The lock allows for two user codes. To set an additional passcode follow the procedure above but press **2** → **ENTER** after pressing the programming button.

One-time passcode registration

A one-time passcode ensures the integrity of your code no matter who is in the room when you access your safe. To set a one-time passcode follow the procedure above but press **3** → **ENTER** after pressing the programming button.

⚠ The one-time passcode will expire once used.

💡 The passcode can be set between 3-12 digits

Opening the safe

- 1 touch the panel

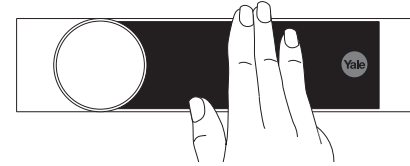

- 2 insert code → press key

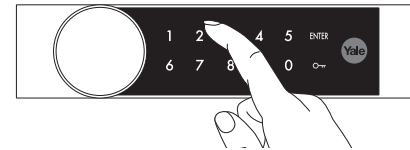

- 3 turn the knob and open the safe

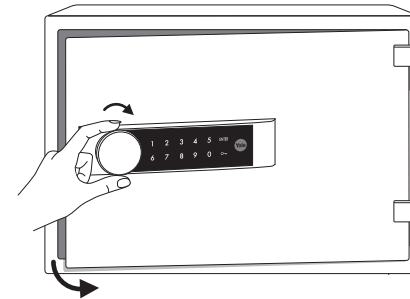

Closing the safe

- 1 close door

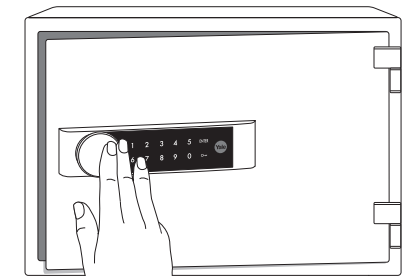

- 2 turn the knob

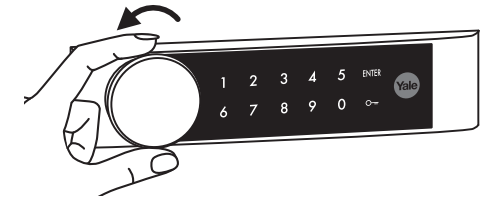

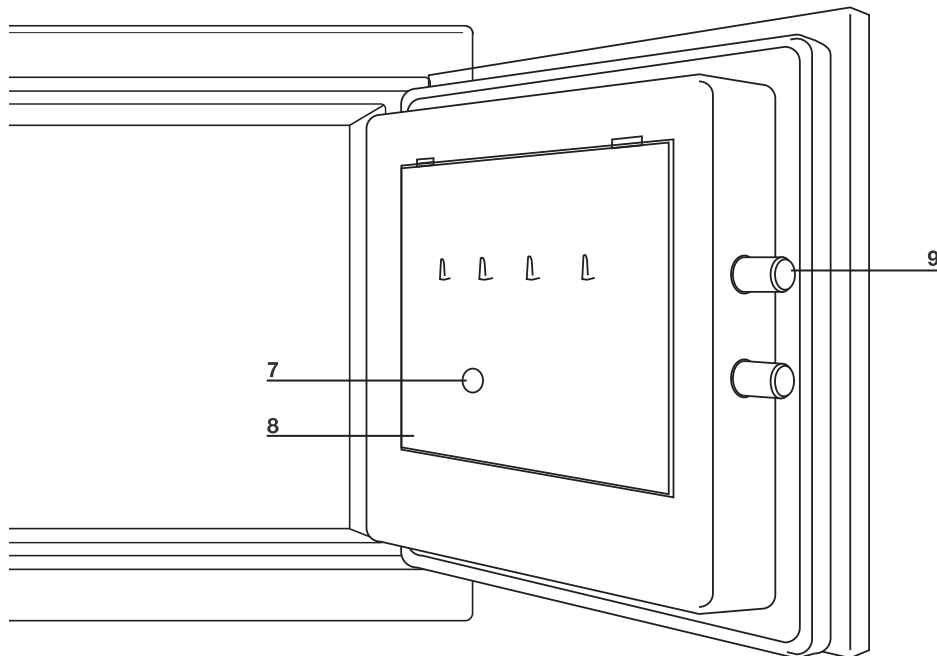
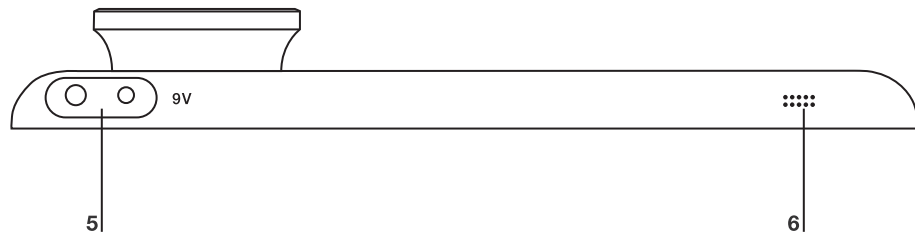
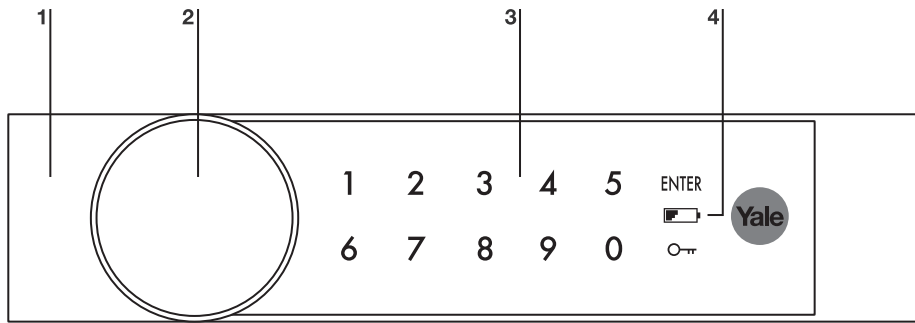

⚠ When closing the door ensure the bolts are fully retracted and that the knob can't be turned to the open position.





Safe overview

- 1 Faceplate
- 2 Knob
- 3 Touch panel
- 4 Low battery indicator
- 5 9V battery connector
- 6 Speaker
- 7 Programming button
- 8 Battery compartment
- 9 Locking bolts

 This product is heavy, be careful when handling it since it can cause injury.

 The safe is delivered with the door in the open position. If you accidentally close the door before installing the batteries follow instructions to open the safe with an emergency battery. If you accidentally close the safe before setting a personal passcode the pre-programmed factory code is 1 2 3 4.

 Please note that your user code does not have to be reset when new batteries are installed.

 When batteries need changing these will be a warning sound when you open the safe.

Installing the batteries

Before using your Yale safe you must insert batteries. The safe requires 4 “AA” (1.5V R06) – which are included.

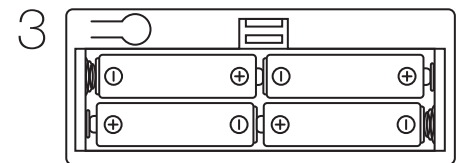
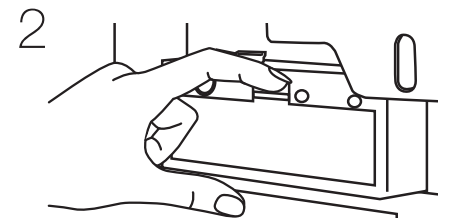
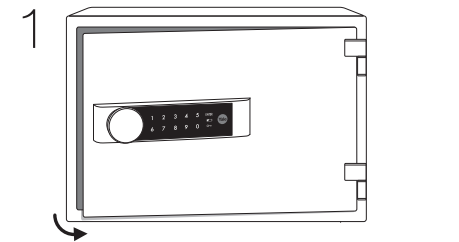

- 1 Open the safe.
- 2 Remove the battery cover located on the rear of the door.
- 3 Place the batteries according to the illustration at the back of the battery compartment. Once the batteries are installed, close the battery compartment.

Scramble code

A scramble number input enables personal codes to be hidden within longer sequences of numbers. The scramble number can be used either before or after the user code.

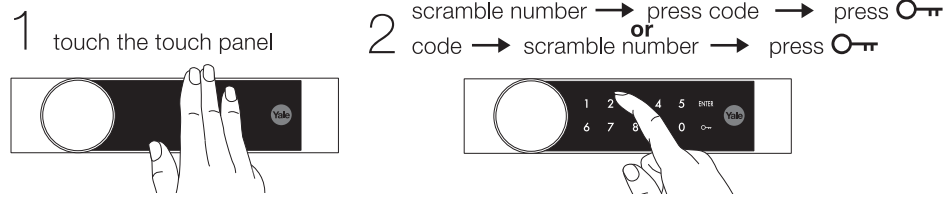

Silent opening

Silent input lets you temporarily turn off the feedback signals from the safe to increase your privacy.

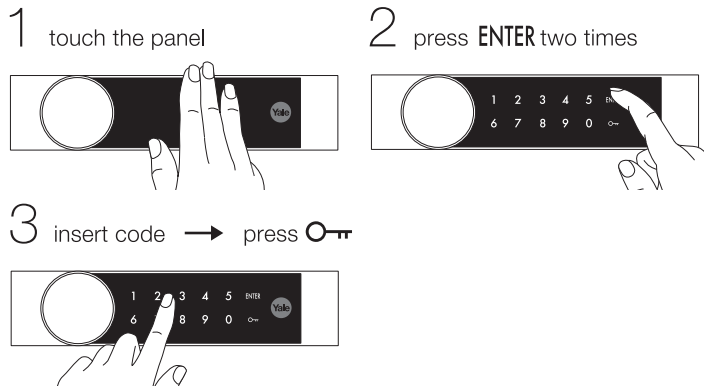

Sound on / off

The audio feedback can also be completely turned off.

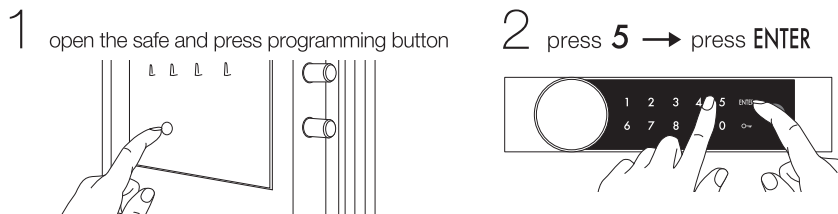

Time lock period setting

If the wrong code is entered more than 5 times the safe will lock down for a period of time that can be set to 3-9 minutes.

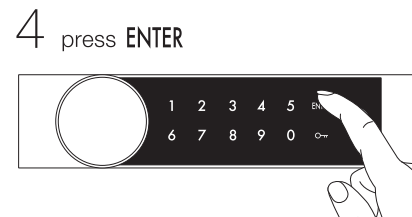
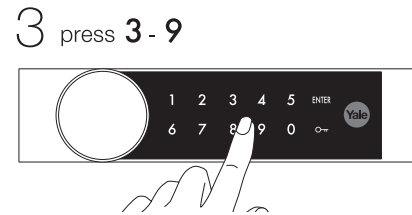
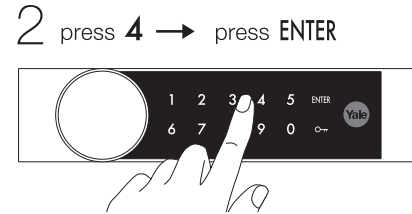
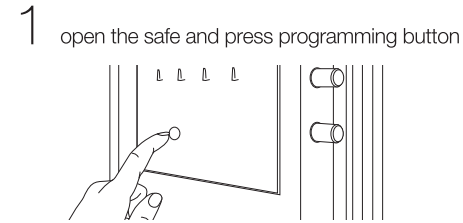

 Note, when the time lock sets in the touch pad will not respond until the until the lock down period has passed.

Lock-down period

To prevent any access to the safe you can manually lock the safe down for 01-48 hours.

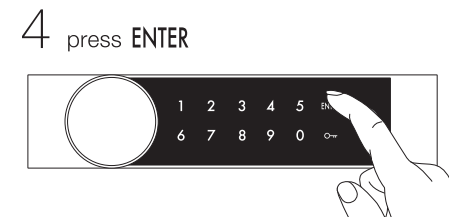
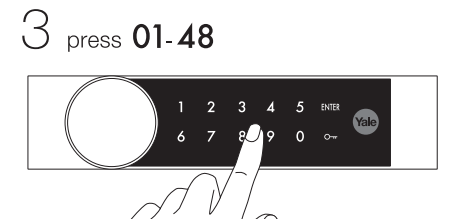
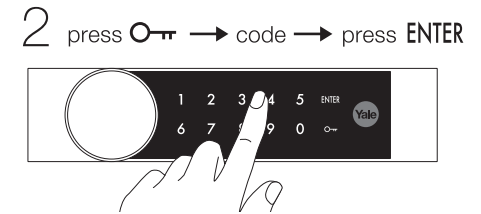
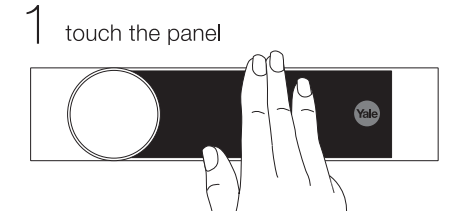

 Note, during the lock-down period the safe panel will shut down completely, no-one will be able to operate the safe.